

SCHEME TOTALS

PLANNING	TOTAL
PLANNING	100
TOTAL	100

USE	AREA	REMARKS
RESIDENTIAL	100	
COMMERCIAL	0	
INDUSTRIAL	0	
RECREATION	0	
OPEN SPACE	0	
ROADS	0	
UTILITIES	0	
TOTAL	100	

REVISED  
 DRAWN  
 SCALE 1:500  
 TRACED BY  
 BULGARIAN

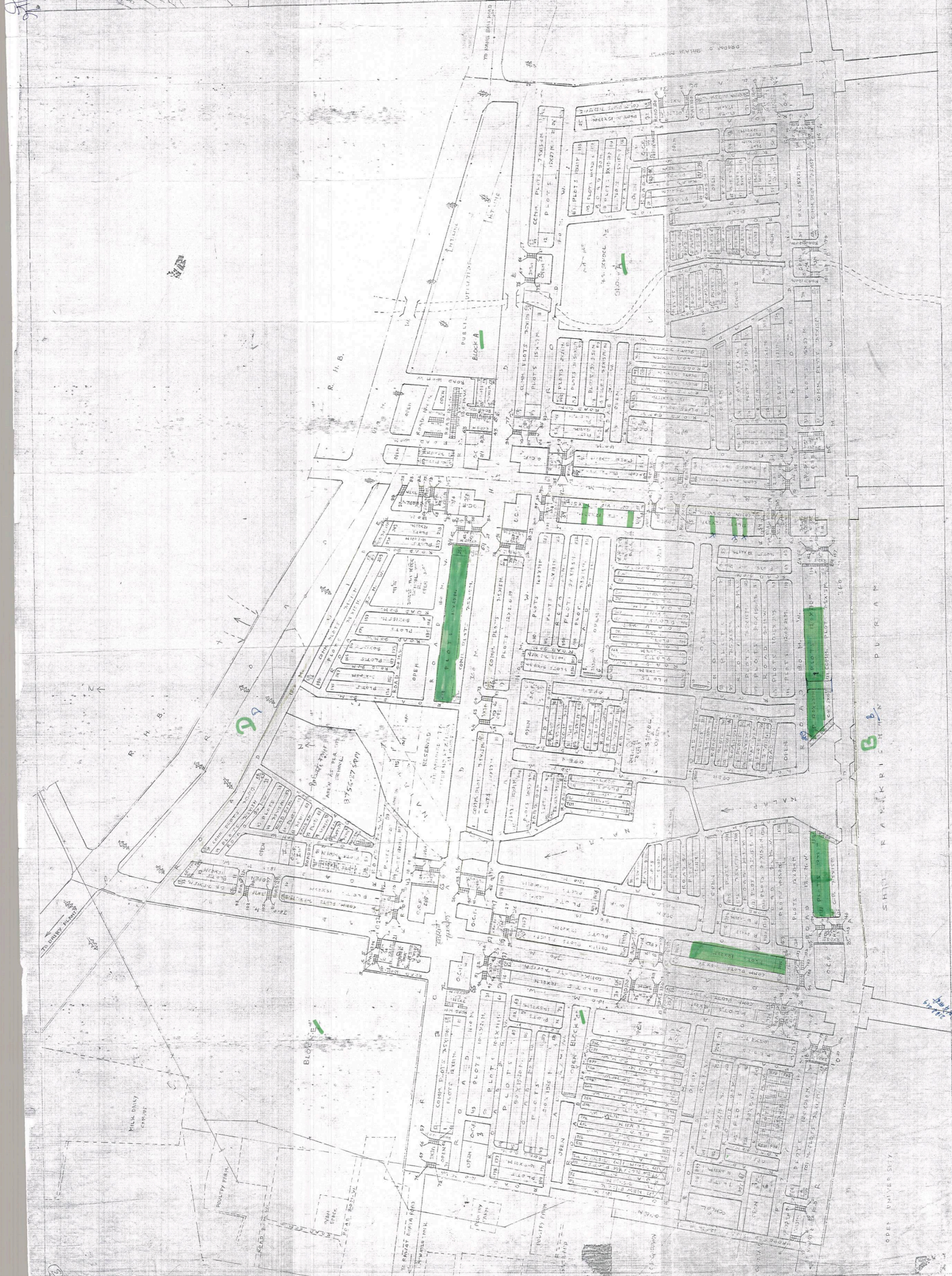

SHIL FAKKIPURAM

OPEN UNIVERSITY



स्वामी विवेकानंद नगर  
(कमसाधिक)

KOTA



PART REVISED PART PLAN SCHEME

SWAMI VIVEKA  
SCHEMATIC PLAN (PART)

SCHEDULE OF PLOTS

S.NO	PLOT NO.	SIZE	AREA SQM	SET BACKS	NO. OF	HT.	STD. EAK	MAX. EAK
1	CP-1	36 x 69M	2484	12 6 6 6	3	3.5	355	250
2	CP-2	36 x 62M	2212	12 6 6 6	2	3.5	355	250
3	CP-3	35X-67M	2365	12 6 6 6	2	3.5	355	250
4	CP-4	36 X 60M	2160	12 6 6 6	15	3.5	355	250
5	CP-5	36 X 50M	1800	12 6 6 6	2	3.5	355	250
6	CP-6	36 X 40M	1440	12 6 6 6	2	3.5	355	250
7	SHOPS	3 X 4-5	15-50	-	-	-	3.6	-
8	SHOPS	3 X 3	9-9	-	-	-	3.6	-

- 30 X 3-0
- 30 X 4-50 M.
- 750 X 17-0 M.
- 90 X 18-0 M.

NOTE:-  
1- REVISED PART PLAN OF COMMERCIAL BLOCKS ALONG THE MAIN ROAD IS TECHNICALLY APPROVED AS PER DECISION TAKEN IN TRUST MEETING NO. 186 DATED 27-07-2016

Senior Town Planner  
U. I. T. KOTA

PART REVISED SCHEME OF COMMERCIAL BLOCKS SWAMI VIVEKANAND NAGAR KOTA (PART)

SURVEYED BY	U. I. T. KOTA
	SCALE 1CM=20M
DRAWN BY	U. I. T. KOTA
	DEPUTY TOWN PLANNER
CHECKED BY	U. I. T. KOTA
	DEPUTY TOWN PLANNER

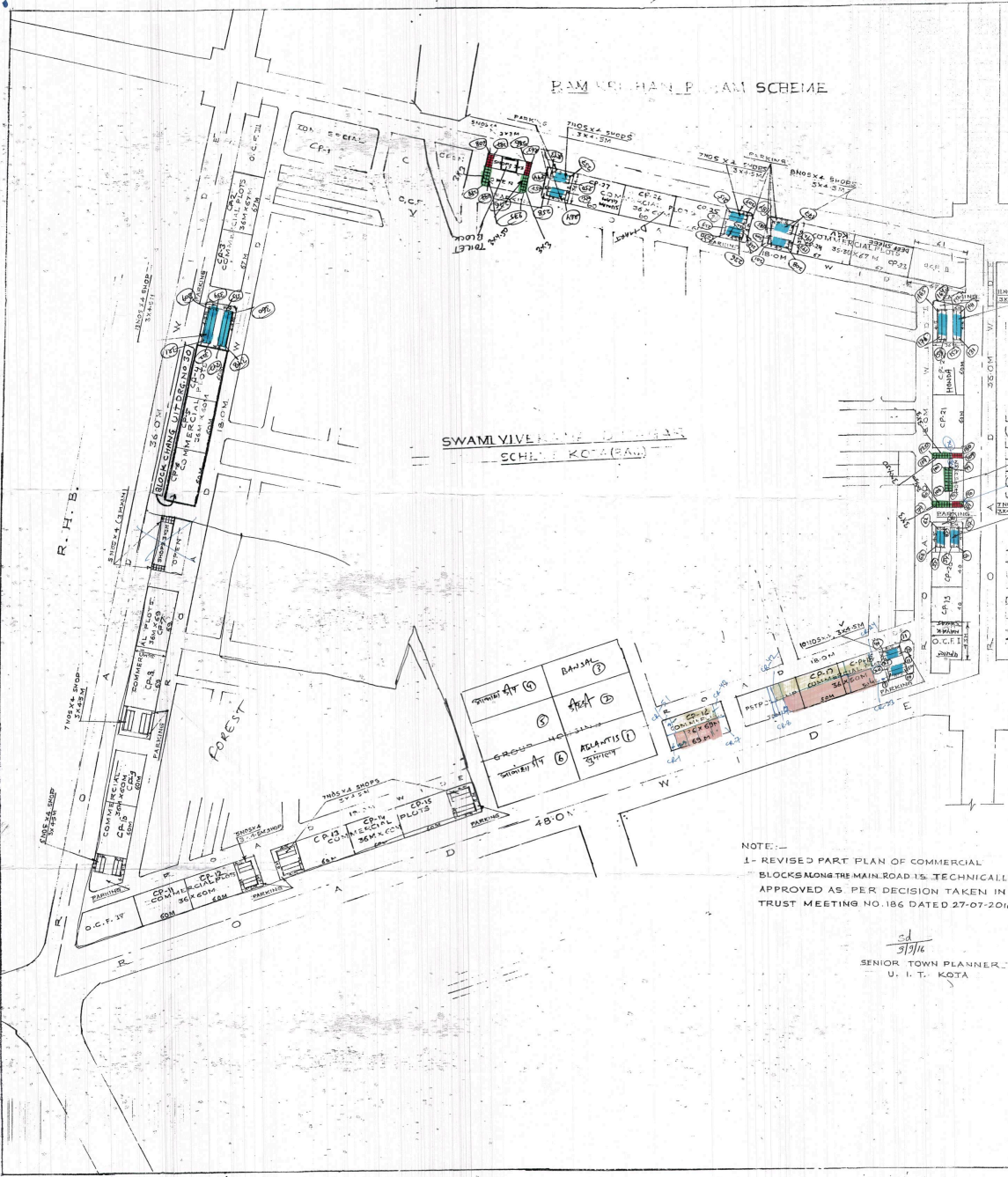



M.H.S. HOUSING

MAHAVIRNAGAR I SCHEME

TO AERODROME

KOTA

DATE OF ISSUE  
18/12

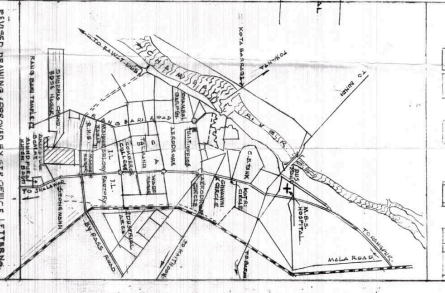
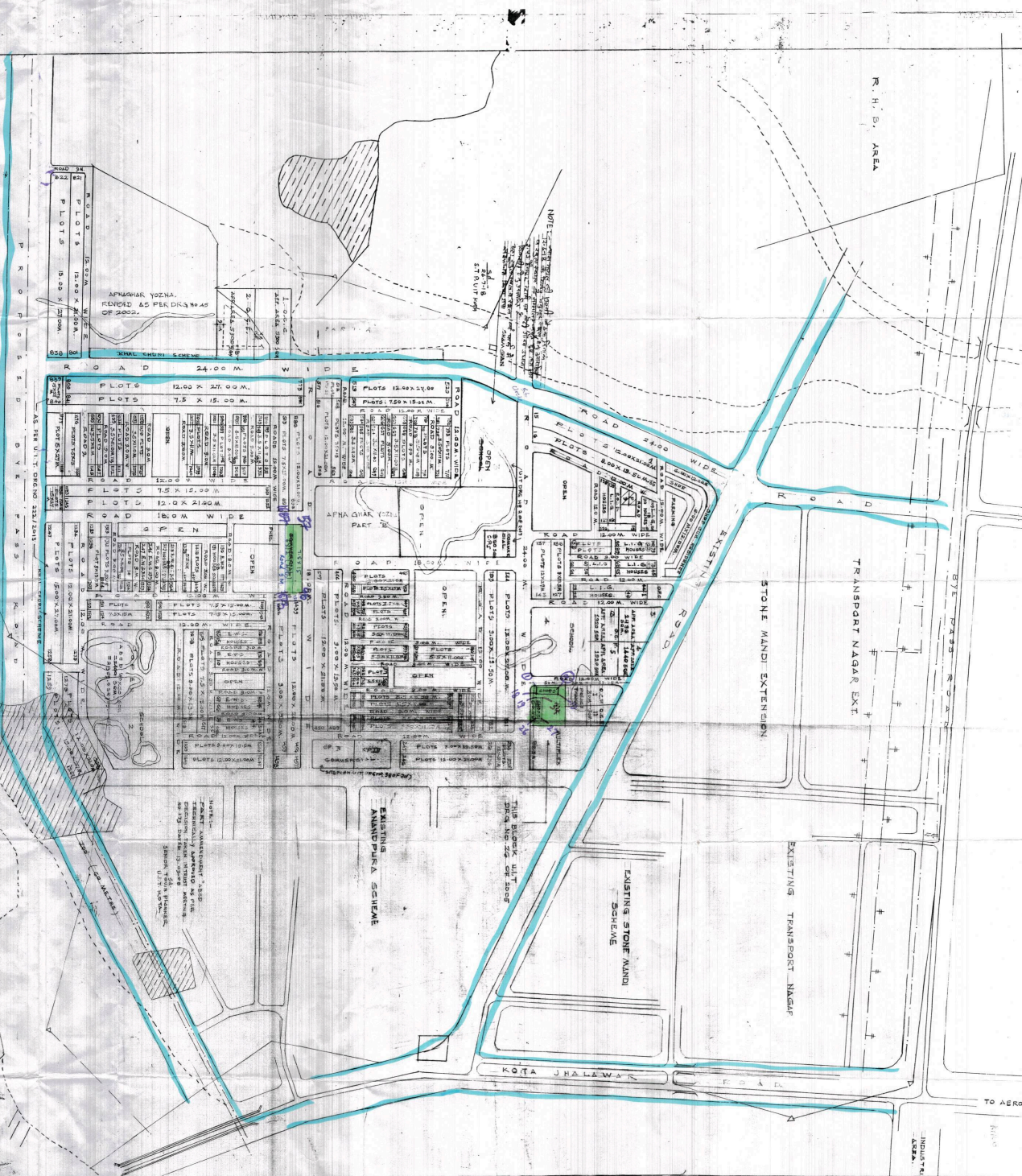

PLANNED HOUSING APPROVED BY THE OFFICE LETTER NO. KTA/154/1000 DATED 10/01/2011 IN ACCORDANCE WITH E.M.S. & L.I.A. HOUSING TO BE CONSTITUTED BY URT.  
BLOCKS PROPOSED FOR L.M.S.-I, L.I.A. HOUSING  
AREA SHOWN THIS PLAN IS 107  
OF 1070 35 YH = 215

NOTE - ALL CONDUITS, PIPES, TRENCHES, WAYS, FURNACE, WELLS, ETC. ARE TO BE LAYED AS PER SHOWN ENCLOSURE  
L.M.S. HOUSING AREAS SHALL BE 100%  
L.I.A. HOUSING AREAS SHALL BE 100%  
PLANNED HOUSING SHALL BE 100%  
UNUTILISED FROM PROPERTY REDISTRIBUTION SHALL BE  
TO CONSTRUCTION THROUGH URT USE CANCELLED.

**LAND USE ANALYSIS**

USE OF LAND	AREA IN HACT	PERCENTAGE
1. RESIDENTIAL	20.072	38.87%
2. ROAD & PARK	18.774	31.74%
3. OPEN	5.504	10.20%
4. COMMERCIAL	5.504	10.20%
5. O.C.M.	1.101	2.04%
TOTAL	50.957	100.00%

**SCHEME AREA SPREAD THIS**

TOTAL SCHEME 50.957 HACT

S.No.	Plot No.	Area in Hact	Use
1	1	1.000	Residential
2	2	1.000	Residential
3	3	1.000	Residential
4	4	1.000	Residential
5	5	1.000	Residential
6	6	1.000	Residential
7	7	1.000	Residential
8	8	1.000	Residential
9	9	1.000	Residential
10	10	1.000	Residential
11	11	1.000	Residential
12	12	1.000	Residential
13	13	1.000	Residential
14	14	1.000	Residential
15	15	1.000	Residential
16	16	1.000	Residential
17	17	1.000	Residential

**PROPOSED REVISED SUBMISH CHAND BOSE NAGAR SCHEME, KOTA (RAI)**

NOTE: DISCREPANCY FROM URT, ENG. NO. 1 OF 10/11/11

DESIGNED BY: M.L. MALHOTRA

CHECKED BY: S.P. RAJAN

DATE: 18/12/2011











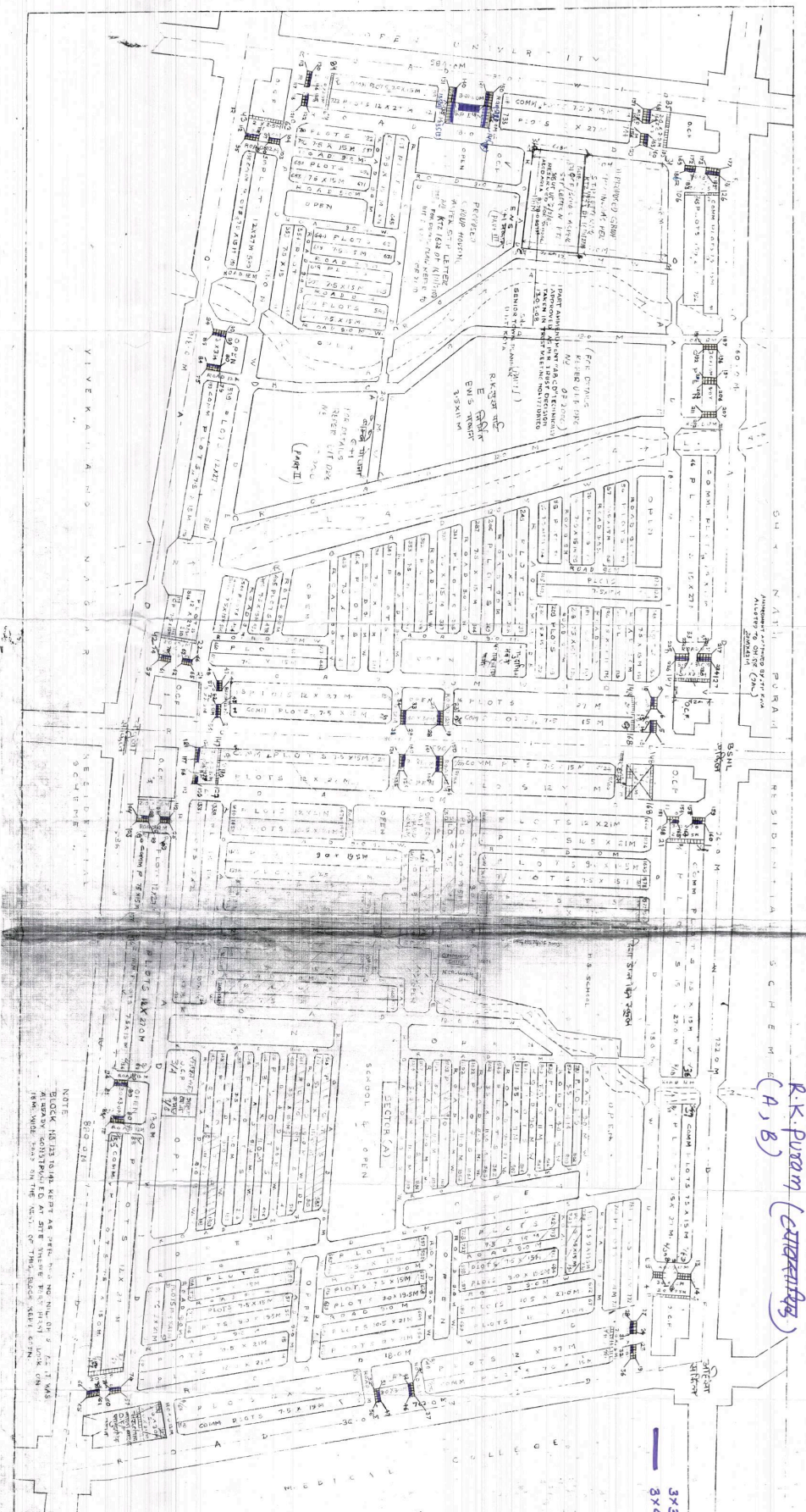

R.K. Puram (A, B)  
 (SHEKHAR NAGAR)

NOTE:  
 ALL DIMENSIONS ARE IN METERS AND MILLIMETERS.  
 ALL DIMENSIONS ARE TO FACE UNLESS SPECIFIED OTHERWISE.  
 ALL DIMENSIONS ARE TO FACE UNLESS SPECIFIED OTHERWISE.  
 ALL DIMENSIONS ARE TO FACE UNLESS SPECIFIED OTHERWISE.

**SCHEDULE OF PLANS**

NO.	DESCRIPTION	DATE	BY	SCALE
1	Site plan	10/10/2018	...	...
2	...	...	...	...
3	...	...	...	...
4	...	...	...	...
5	...	...	...	...
6	...	...	...	...
7	...	...	...	...
8	...	...	...	...
9	...	...	...	...
10	...	...	...	...
11	...	...	...	...
12	...	...	...	...
13	...	...	...	...
14	...	...	...	...
15	...	...	...	...
16	...	...	...	...
17	...	...	...	...
18	...	...	...	...
19	...	...	...	...
20	...	...	...	...
21	...	...	...	...
22	...	...	...	...
23	...	...	...	...
24	...	...	...	...
25	...	...	...	...
26	...	...	...	...
27	...	...	...	...
28	...	...	...	...
29	...	...	...	...
30	...	...	...	...
31	...	...	...	...
32	...	...	...	...
33	...	...	...	...
34	...	...	...	...
35	...	...	...	...
36	...	...	...	...
37	...	...	...	...
38	...	...	...	...
39	...	...	...	...
40	...	...	...	...
41	...	...	...	...
42	...	...	...	...
43	...	...	...	...
44	...	...	...	...
45	...	...	...	...
46	...	...	...	...
47	...	...	...	...
48	...	...	...	...
49	...	...	...	...
50	...	...	...	...
51	...	...	...	...
52	...	...	...	...
53	...	...	...	...
54	...	...	...	...
55	...	...	...	...
56	...	...	...	...
57	...	...	...	...
58	...	...	...	...
59	...	...	...	...
60	...	...	...	...
61	...	...	...	...
62	...	...	...	...
63	...	...	...	...
64	...	...	...	...
65	...	...	...	...
66	...	...	...	...
67	...	...	...	...
68	...	...	...	...
69	...	...	...	...
70	...	...	...	...
71	...	...	...	...
72	...	...	...	...
73	...	...	...	...
74	...	...	...	...
75	...	...	...	...
76	...	...	...	...
77	...	...	...	...
78	...	...	...	...
79	...	...	...	...
80	...	...	...	...
81	...	...	...	...
82	...	...	...	...
83	...	...	...	...
84	...	...	...	...
85	...	...	...	...
86	...	...	...	...
87	...	...	...	...
88	...	...	...	...
89	...	...	...	...
90	...	...	...	...
91	...	...	...	...
92	...	...	...	...
93	...	...	...	...
94	...	...	...	...
95	...	...	...	...
96	...	...	...	...
97	...	...	...	...
98	...	...	...	...
99	...	...	...	...
100	...	...	...	...

KEY PLAN  
 SHEKHAR NAGAR  
 SHRI RAM KRISHNA PURAM  
 SCALE: 1:1000

SCHEM. AREA SHOWN THIS ...  
 TOTAL SCHEM. AREA 109.48 HECT.

LAND USE ANALYSIS

DATE: 10/10/2018  
 BY: ...  
 SCALE: 1:1000

DESIGNED BY: ...  
 CHECKED BY: ...  
 APPROVED BY: ...



स्वामी विवेकानंद (स्वामीजी)

# KOTA



KEY PLAN  
SCALE: 1:1765

TOTAL SCHEME AREA 7350 HECT  
SCHEME AREA SHOWN THIS

NO.	LAND USE	ANALYSIS	AREA (IN HECT)	PERCENTAGE
1	RESIDENTIAL	45.07	22.26	
2	COMM. & P. PAMP	10.45	14.09	
3	SCHOOL	06.23	08.47	
4	OFFER'S PARK	02.24	03.05	
5	AREA UNDER NAAM	00.00	00.00	
6	R.O.P.D.	05.77	07.85	
7	TOTAL	73.76	100.00	

SCHEDULE OF PLOTS

S.NO.	DATE OF PROVISION	SET BACK	TYPE	NO. OF PLOTS	NO. OF CONN.
1	30X20 M	FRONT REAR SIDE	SHOPS	90	90
2	120X36.5 M		EDUMM	622	163
3	50X90 M		EDUMM	460	115
4	60X120 M		EDUMM	96	24
5	70X150 M		EDUMM	96	24
6	80X180 M		EDUMM	96	24
7	100X210 M		EDUMM	96	24
	TOTAL			2036	510

NOTE: 1. PROPER DRAINAGE OF AREA BE ENSURED DURING VIEW FROM SWAMI DURING FLOOD AS THE SECTION AND POSITION OF BUILDINGS BEING REVISED BY DATE 11/11/2010

2. REVISED SCHEME APPROVED BY STP LETTER NO. KTZ-1423 DATED 16/12/2009

3. K.TZ-1423 DATED 16/12/2009

4. B.S.P. BLOCKS BEING REVISED TO HAVE 30% BATH WITH DETAILS OF 180M, 30M WIDE ROAD & PARK

5. CROSSING SHALL BE MARKED OUT SEPARATELY

6. REST OF THE PROVISIONS BE KEPT AS PER ENCLER APPROVE SCHEME

7. ALIENMENT OF NAAM FOR SWAMI HOUSE APPROVAL BE SUBMITTED TO THE TECHNICAL DEPT. OF ENCLER (CIR-MUMBAI) AS PER TECHNICAL REPORT OF ENCLER SECTION (S.E. DIV. II)

8. MEASUREMENT GIVEN BY XEN DIV II

9. THE DRG. SUPERSEDED BY THE DRG. NO. 32 OF 38

10. THE BLOCK SHALL BE BASED ON PLANNING PARAMETERS MENTIONED IN STP LETTER NO. KTZ-1423 DATED 16/12/2009

REVISED  
RESIDENTIAL SCHEME SWAMI VIVEKANAND NAGAR KOTA (P&T)

DATE (BY P)	UTI DRG NO DT. OF 2009
SCALE	SCALE: 1CM = 20M
TRACED BY	ASST. TOWN PLANNER U. T. KOTA
TOWN PLANNING ASSTT.	DEPUTY TOWN PLANNER U. T. KOTA



REVISIONS MADE AT SITE POST THE REVISED FROM TOURISTS TO SWAMI VIVEKANAND MEDICAL COLLEGE STP LETTER NO. KTZ-1423 DATED 16/12/2009

DATE: 11/11/2010



2014 11/1  
 CAPRI/2014

# KOTA

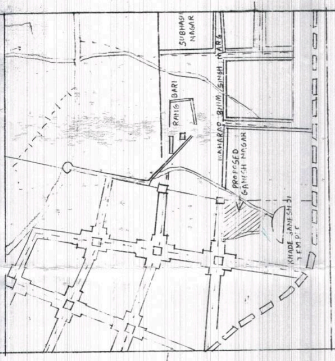

KEY PLAN



TOTAL SCHEME AREA 19.44 HECT.  
 SCHEME AREA SHOWN THUS

LAND USE ANALYSIS

S.N.	USE OF LAND	AREA IN HECT	PERCENTAGE
1.	RESIDENTIAL	12.95	66.67%
2.	ROAD	2.79	14.35%
3.	OPEN PARKS & GRAND	2.32	11.93%
4.	SCHOOL	1.50	7.71%
5.	COMMERCIAL	2.61	13.33%
6.	O.C.F.	0.65	3.35%
TOTAL		19.44	100.00%

SCHEDULE OF PLOTS

S.N.	AREA IN HECT	SET BACKS		TYPE	QUANT
		FRONT	BACK		
1.	75.54 (1.50)	3 M	15 M	M.G. 2	48
2.	75.54 (1.50)	NIL	NIL	M.G. 2	47
3.	75.54 (1.50)	NIL	NIL	M.G. 2	363
4.	75.54 (1.50)	NIL	NIL	E.W. 5	360
TOTAL					795

NOTE:-  
 1. DRAWING TRACED FROM U.T. DRG No. 46 of 92.  
 2. AS PER SET PILETTOR No. K22/143/07 DATED 16/8/94  
 3. SIDE SET BACK HAS BEEN DELETED IN PLOT SIZE  
 75.54 IN THIS IS NOT APPLICABLE FOR CORNER  
 PLOTS.

APPROVED BY SETP LETTER NO. RTH 162/168/1687 DATE 16/7/92

## PROPOSED GANESH NAGAR RESIDENTIAL SCHEME KOTA

U.T. DRG No. OF 1995  
 SCALE 1 CM = 10 M.

TRACED BY:  
 B. GUNJARIA

CHECKED BY:  
 DEPUTY TOWN PLANNER  
 V. I. T. KOTA.



TALAB KHAI (GATE NO. 17)